

NOVA LUCE

9186972

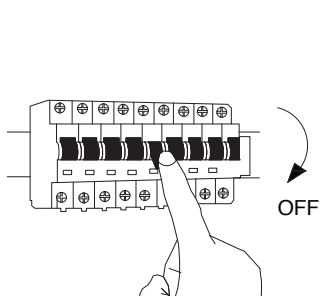

1. Turn off the general switch

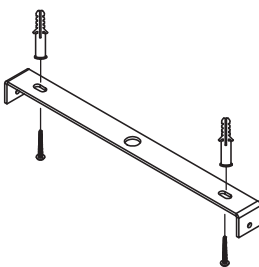

2. Align drill holes apply plastic anchors
With screws

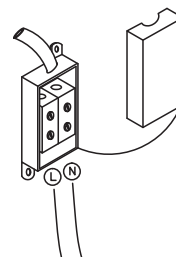

3. Connect the wires

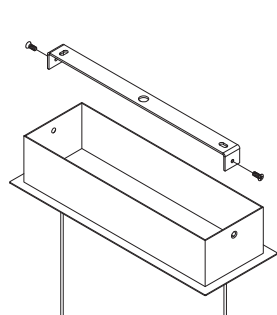

4. Apply the side screws

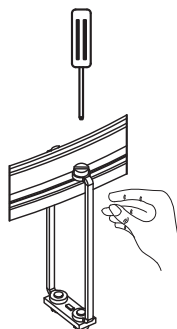

5. Fix it in place

When the frames or LEDs are not straight, please loosen one screw and straighten them by hand, then tighten the screw.

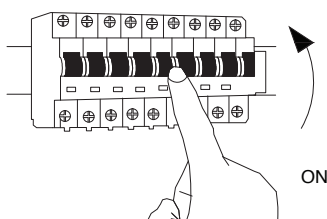

6. Turn on general switch

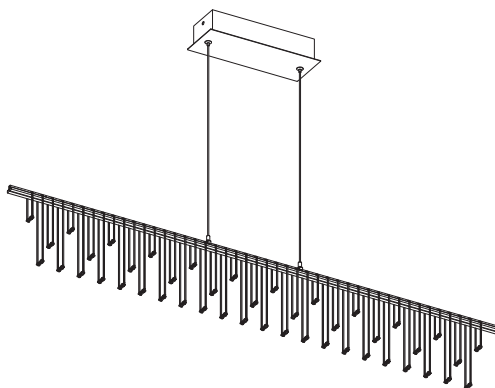

- a) This light fitting operates at a normal supply voltage of 220-240V.
- b) When changing the bulb or fuses, always switch off at the mains and allow the old bulb to cool down before handling.